

RFID Reader RF-220

Rapid body camera
allocation device



Connect an RFID reader RF-220 to a DockController DC-200 or EdgeController EC-220 to make body camera allocation quicker and easier, using your organisation's existing ID or access cards.

GENERAL INFORMATION

| | |
|---------------------------|--|
| Marketing name | RF-220 |
| Typical usage | Attached to a DC-200 or EC-220 via USB connection |
| Management software | VideoManager 9.1 onwards (for High & Low frequency card support) |
| Warranty | 1 year return to Motorola Solutions warranty |
| Includes snap-in holder | The Snap-in Holder is used to fix the RF-220 to a flat surface |
| Manufacturing information | Made For Motorola Solutions by ELATEC GmbH, Zeppelinstr. 1, 82178 Puchheim, Germany Model name: Elatec TWN4 MultiTech2 LF HF* |

SIZE AND WEIGHT

| | |
|------------|-----------------------|
| Dimensions | 88 mm x 56 mm x 18 mm |
| Weight | 115 g |

TECHNICAL SPECIFICATIONS

| | |
|-------------------------------------|---|
| Frequency | Low Frequency: 134.2 kHz |
| | High Frequency: 13.56 MHz |
| Read/write distance | Low Frequency and High Frequency: 100 mm (4 in) |
| Supported compatible card standards | Including but not limited to: ISO1443A (e.g. MIFARE Classic) ISO14443B (e.g. HID iCLASS) ISO15693 (e.g. HID iCLASS SE) This includes Avigilon Control Manager door access cards |
| Operating temperature | 0° to 40°C (32° to 104°F) |
| Storage temperature | -55° to 70°C (-67° to 158°F) |

*Customised configuration for Motorola Solutions

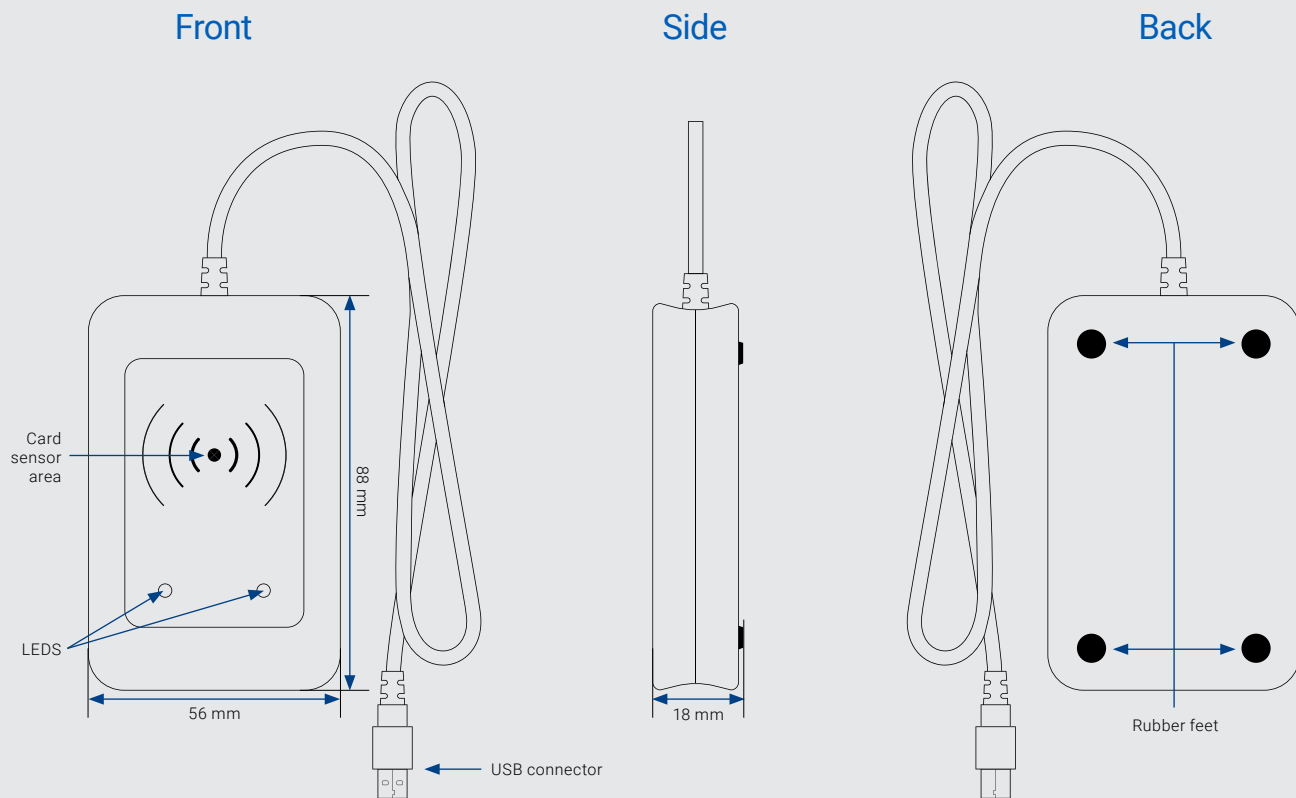

To learn more, visit: www.motorolasolutions.com/BWC



Motorola Solutions Ltd., Nova South, 160 Victoria Street, London, SW1E 5LB, United Kingdom

Available in APAC, EMEA, LATAM and NA.

MOTOROLA, MOTO, MOTOROLA SOLUTIONS and the Stylized M Logo are trademarks or registered trademarks of Motorola Trademark Holdings, LLC and are used under license. All other trademarks are the property of their respective owners. ©2025 Motorola Solutions, Inc. All rights reserved. 02-2025 [EV05]